

# **Tyrrell & Laing** INTERNATIONAL INC.

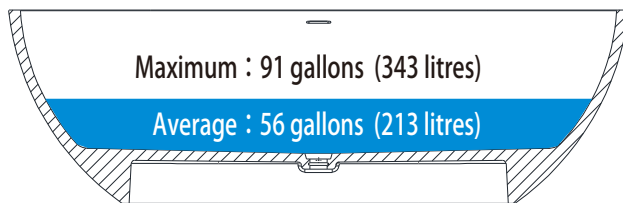

Water consumption

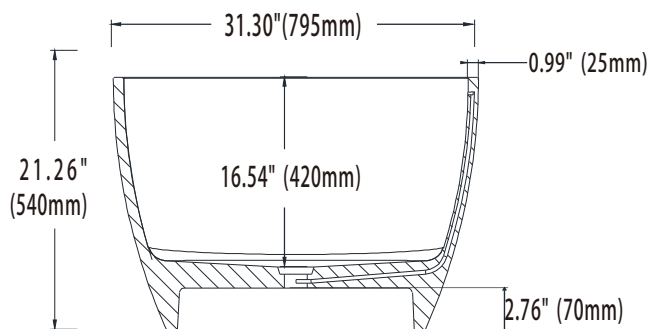
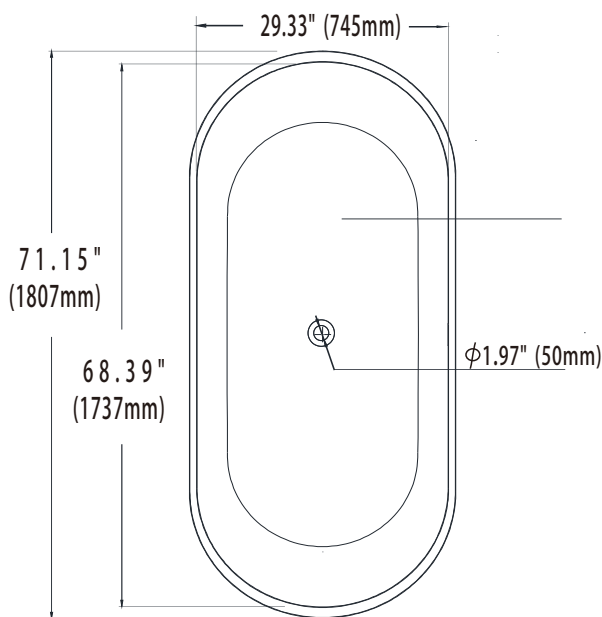

## Model: MAIA-1800

Approximate cast weight: 375 lbs (169 kg)

Water consumption: 56 gallons (213 litres)

Key features include:

Solid one-piece construction with integral overflow

Pre-sloped to drain

Mold and mildew resistant

Bacteria resistant

Non-porous

Stain resistant and easy to clean



Uniform Plumbing Code (UPC ®)

National Plumbing Code of Canada

International Plumbing Code (IPC ®)

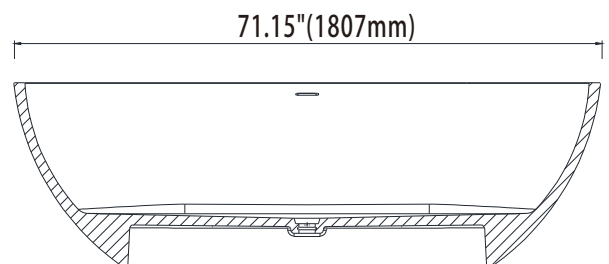

### Overflow Details

